

DataTronix™ Webcam User Manual

DT-WEBCAM-AUTOPAN-WHT
DT-WEBCAM-AUTOPAN-BLK

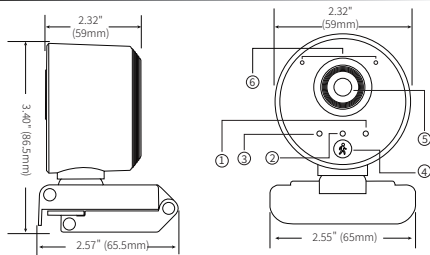

inches (mm)

1. Power indicator	2. Auto tracking indicator	5. HD Lens
3. Signal indicator	4. Auto tracking button	6. MIC

Specifications

Image Sensor	2MP with WDR
Effective auto tracking range	<9.84 ft (< 3 meters)
Lens	3.6mm
Encoding format	MJPEG /H.264
Video resolution	1920 x 1080
Video frame rate	30FPS
Microphone shape	Built-in microphone
Pickup distance	16.4 ft (5 meters)
Audio encoding format	PCM
Audio bit rate	32kbps
Size	2.55" x 2.57" x 3.40" (65 x 65.5 x 86.5mm)
Power supply	USB direct power DC5V
Installation method	Can be placed horizontally on TV, TV cabinet

Setting up your webcam

1. Webcam Placement

Webcam can be clipped to a monitor or placed on a desktop using the included tripod.

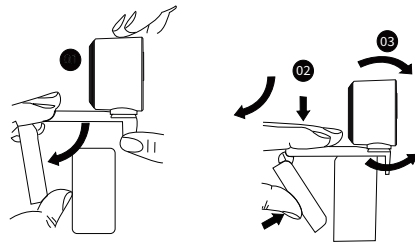

For placement on a monitor

Grasp the webcam as shown and open clip base with your other hand.

Mount the webcam, making sure the foot on the clip base is flush with the back of your monitor.

2. Support AI auto tracking

Effective auto tracking range < 9.84 ft (< 3 meters), for example, when you stand in front of webcam, turn on auto tracking button, it will track you automatically when you move.

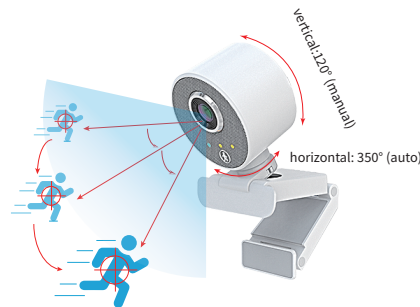

3. WDR Technology

Features Wide Dynamic Range (WDR). WDR balances images that are extremely dark and bright due to lighting and displays one clear image.

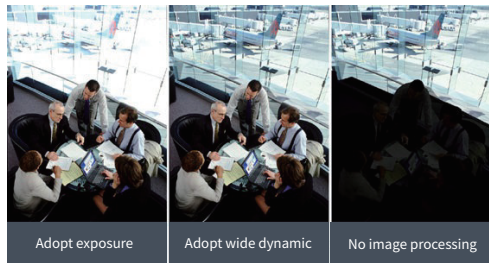

4. Connect your webcam

Plug your webcam into the USB interface of the PC.
Wait about 1 minute, webcam will install automatically.



Getting start with video calling

To take advantage of video calling, both you and the person you call must have a webcam and a video-calling application such as Skype, Yahoo! @Messenger, Windows Live@Messenger or Gmail installed.

- ➔ A computer with speaker(or a headset)and a microphone (your webcam has built-in microphone);
- ➔ A broadband Internet connection (e.g. DSL, T1 or cable);
- ➔ Please check your preferred video calling application requirements. (Requirements may vary between different applications but usually a minimum of 2Mbps upload speed is required);

Q&A:

Q: How do I know if my camera is recognized by the operating system?

A: Connect the camera in any USB 2.0/3.0 port. Once the camera is connected, it takes few more moments before the camera is recognized. To ensure the camera has installed correctly, check the following;
Under Control Panel>System and Security>Device Manager.

Q: How do I know if my video calling application can use my webcam?

A: All video application have an option setting to review the audio and video device. Using the video application review the followings:

The Audio selection to ensure the USB 2.0 camera Microphone is selected.

If not change the selection to the USB 2.0 camera. The Video selection to ensure the USB 2.0 camera is selected.

If not change the selection to the USB 2.0 camera.

DataTronix

610-429-1511 | sales@datatronix.biz | www.datatronix.biz



WARNING: Cancer and Reproductive Harm
www.P65Warnings.ca.gov

This device complies with Part 15 of the FCC Rules. Operation is subject to the following two conditions: 1. This device may not cause harmful interference and 2. This device must accept any interference received, including interference that may cause undesired operation.